

**LEGEND**

- Xx Tree Identified for Preservation (GREEN)
- Xx Tree Identified for Removal (RED)
- TPZ Tree Preservation Zone Symbol
- Tree Preservation Fence Location
- Property Boundary
- Tree location estimated by KFCI
- Minimum Tree Preservation Zone Symbol
- Critical Root Zone Symbol

**Tree Inventory**  
Refer to Table 1 of report revised 17 June 2022 for the complete tree inventory. All trees 10 cm in diameter situated on the subject property, in the City road allowance, and on neighbouring property the within vicinity of the proposed development were included in the tree inventory.

**Tree Removal**  
Removal of 61 trees is required; Trees 1, 44, 46, 61 and 62 require removal to accommodate the proposed condominium complex, and Trees 3-20, 22, 24-26, 38-43, 47-56 and 63-86 require removal to re-construction the Rambo Creek channel.

**Tree Preservation**  
Preservation of six trees (Trees 27-32) will be possible through the use of appropriate tree protection measures. Tree protection measures will have to be implemented prior to the construction phase to ensure trees identified for preservation are not impacted by the proposed development.

No.	Issue/Revisions	Date	By
1	Report Submission	March 18'	JJJ
2	Report Revisions	Jan 19'	JJJ
3	Report Revisions	Sept 21'	KB
4	Report Revisions	Nov. '21	KB
5	Report Revisions	17 June '22	KB

Base Data: R.Avis Surveying Inc.



146 Lakeshore Road West  
PO Box 1267 Lakeshore W PO  
Oakville ON L6K 0B3  
T 289.837.1971  
e: consult@kuntzforestry.ca  
web: www.kuntzforestry.ca

**Mattamy Homes**  
7880 Keele Street, Suite 400  
Vaughan, ON L4K 4G7

Property:  
**2082-2090 James Street**  
Burlington, ON

**Tree Inventory & Preservation Plan**

Project	P2955	<b>Figure 1</b>
Date	17 June 2022	
Scale	1:250	

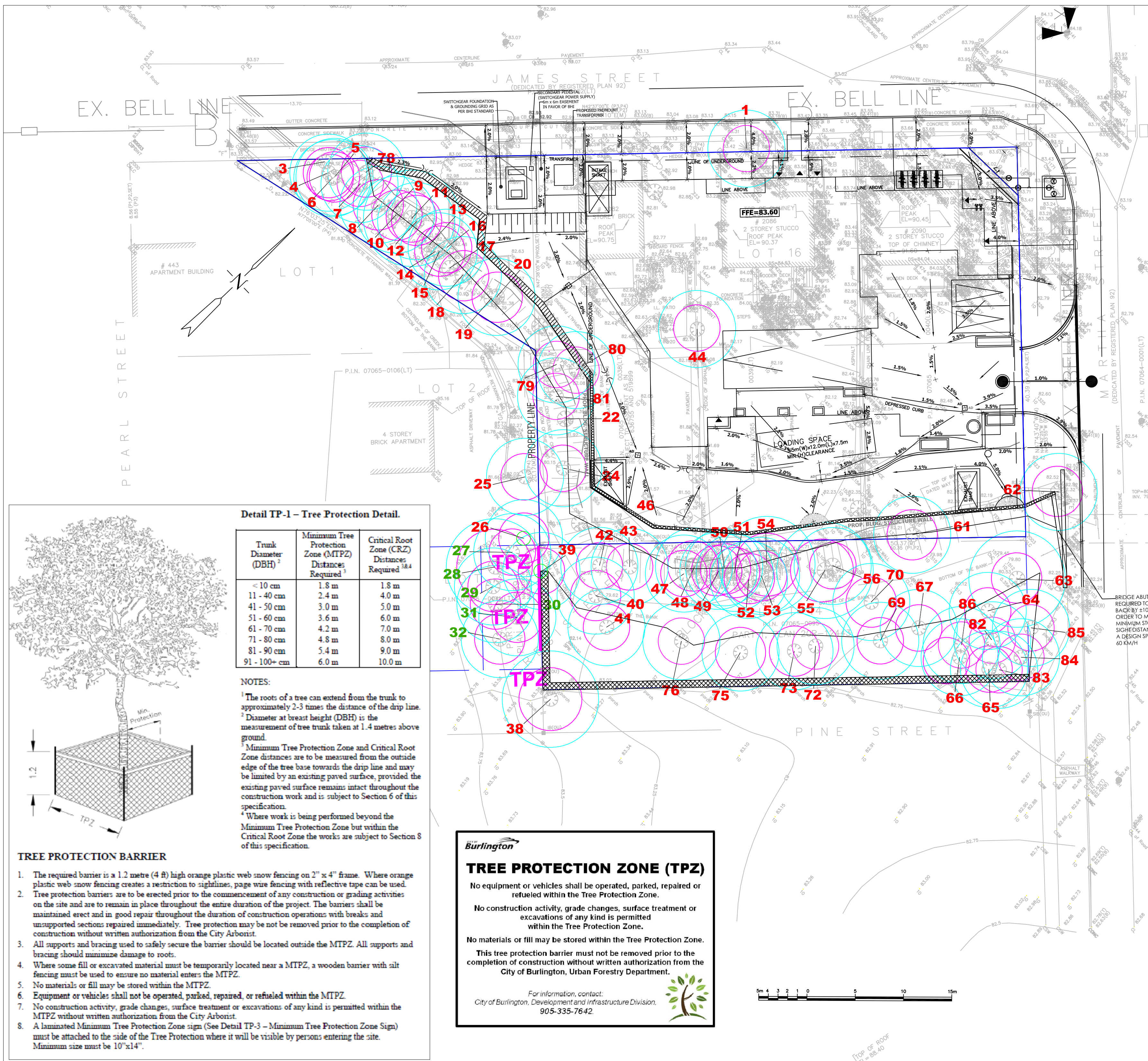

**Detail TP-1 – Tree Protection Detail.**

Trunk Diameter (DBH) <sup>2</sup>	Minimum Tree Protection Zone (MTPZ) Distances Required <sup>1</sup>	Critical Root Zone (CRZ) Distances Required <sup>3,4</sup>
< 10 cm	1.8 m	1.8 m
11 - 40 cm	2.4 m	4.0 m
41 - 50 cm	3.0 m	5.0 m
51 - 60 cm	3.6 m	6.0 m
61 - 70 cm	4.2 m	7.0 m
71 - 80 cm	4.8 m	8.0 m
81 - 90 cm	5.4 m	9.0 m
91 - 100+ cm	6.0 m	10.0 m

**NOTES:**

- The roots of a tree can extend from the trunk to approximately 2-3 times the distance of the drip line.
- Diameter at breast height (DBH) is the measurement of tree trunk taken at 1.4 metres above ground.
- Minimum Tree Protection Zone and Critical Root Zone distances are to be measured from the outside edge of the tree base towards the drip line and may be limited by an existing paved surface, provided the existing paved surface remains intact throughout the construction work and is subject to Section 6 of this specification.
- Where work is being performed beyond the Minimum Tree Protection Zone but within the Critical Root Zone the works are subject to Section 8 of this specification.

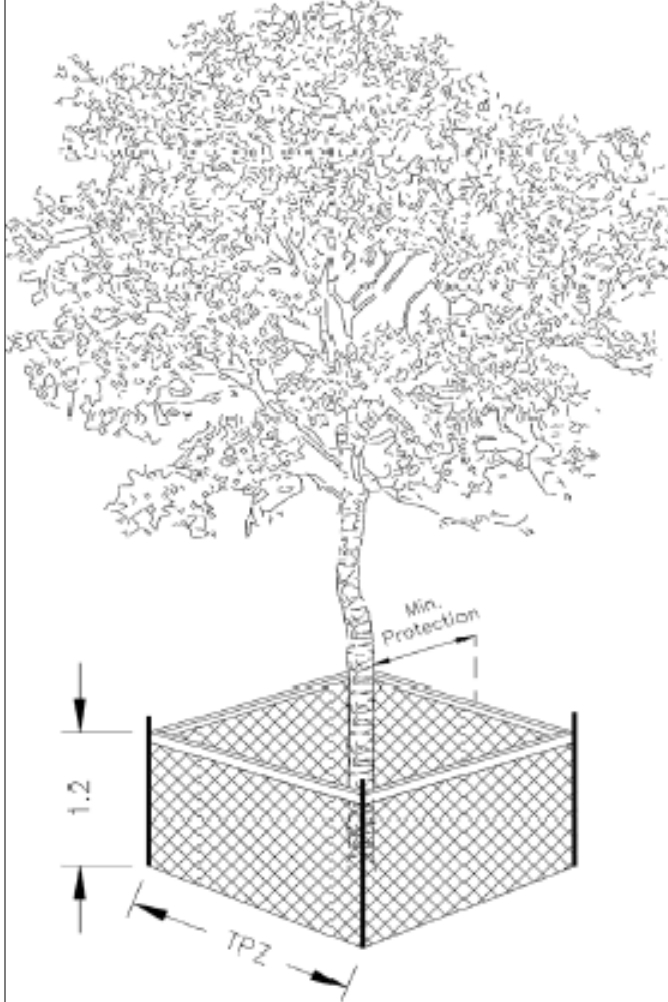

**TREE PROTECTION BARRIER**

- The required barrier is a 1.2 metre (4 ft) high orange plastic web snow fencing on 2" x 4" frame. Where orange plastic web snow fencing creates a restriction to sightlines, reflective tape can be used.
- Tree protection barriers are to be erected prior to the commencement of any construction or grading activities on the site and are to remain in place throughout the entire duration of the project. The barriers shall be maintained erect and in good repair throughout the duration of construction operations with breaks and unsupported sections repaired immediately. Tree protection may not be removed prior to the completion of construction without written authorization from the City Arborist.
- All supports and bracing used to safely secure the barrier should be located outside the MTPZ. All supports and bracing should minimize damage to roots.
- Where some fill or excavated material must be temporarily located near a MTPZ, a wooden barrier with silt fencing must be used to ensure no material enters the MTPZ.
- No materials or fill may be stored within the MTPZ.
- Equipment or vehicles shall not be operated, parked, repaired, or refueled within the MTPZ.
- No construction activity, grade changes, surface treatment or excavations of any kind is permitted within the MTPZ without written authorization from the City Arborist.
- A laminated Minimum Tree Protection Zone sign (See Detail TP-3 – Minimum Tree Protection Zone Sign) must be attached to the side of the Tree Protection where it will be visible by persons entering the site. Minimum size must be 10"x14".

**Burlington**

**TREE PROTECTION ZONE (TPZ)**

No equipment or vehicles shall be operated, parked, repaired or refueled within the Tree Protection Zone.

No construction activity, grade changes, surface treatment or excavations of any kind is permitted within the Tree Protection Zone.

No materials or fill may be stored within the Tree Protection Zone.

This tree protection barrier must not be removed prior to the completion of construction without written authorization from the City of Burlington, Urban Forestry Department.

For information, contact:  
City of Burlington, Development and Infrastructure Division,  
905-335-7642.



