



THIS REPORT IS STILL UNDER
REVIEW BY STAFF AND IS NOT
CONSIDERED THE FINAL
APPROVED DOCUMENT.

THIS DOCUMENT IS PROVIDED
FOR INFORMATIONAL PURPOSES
TO SUPPORT THE PUBLIC TREE
REMOVAL REPORT TO COUNCIL
RPF 14-23 FOR TREE #M1.

Prepared for:

Carrothers & Associates
505 York Boulevard
Hamilton, ON
905-574-1504

Project Address:

603 Woodland Avenue, Burlington, Ontario
DENG File # n/a

Data Collection and Report Prepared by:
Stephen Shelton ON-0542AT, TRAQ 1589
steve@summitsks.ca

1 April 2022

Revised 12 October 2022

Arborist Report - 603 Woodland Avenue, Burlington, Ontario

| | |
|----------------------------------|----------|
| Project Overview | 3 |
| Municipal Trees | 3 |
| Neighbouring Trees | 4 |
| Private Trees | 4 |
| Data Graph | 5 |
| Limitations of Assessment | 6 |
| Author's Qualifications | 7 |
| Tree Protection Plan | 8 |

Arborist Report - 603 Woodland Avenue, Burlington, Ontario

Summit SKS Limited have been retained by the property owner to prepare this Arborist Report and Tree Protection Plan for 603 Woodland Avenue in Burlington, Ontario. The owner intends to demolish the existing house and build a new one. The tree assessment was completed on the 26th day of March 2022. All field and appraisal work was conducted by qualified consultants in accordance with Public Tree By-law (68-2013) and the Private Tree By-law (02-2020).

The purpose of this report is to inventory and assess trees 15cm in diameter, measured at breast height and larger on the subject property, in the city road allowance adjacent to the property and any trees within 6m of the property line.

There are two (2) existing trees that are recommended for removal as a result of this proposed construction. The City of Burlington will require four (4) compensatory trees to be replanted or cash in lieu in the amount of \$1000.00 (\$250/tree).

Municipally Owned Trees

Tree number M1 is a 9, 9, 9, 10cm dbh Maple Red (soft maple) that is growing on the municipally owned boulevard. This tree is in fair condition and requires a tree protection zone of 2.4m.



| Tree Number | Tree Species | Diameter of Appraised Tree (cm) | Area Of Appraised Tree (cm) | Diameter of Replacement Tree (cm) | Area of the Replacement Tree (cm) | Cost of Replacement Tree | Basic Price | Species Rating | Basic Value | Location Rating | Conditions Rating | Appraised Value |
|-------------|--------------|---------------------------------|-----------------------------|-----------------------------------|-----------------------------------|--------------------------|-------------|----------------|-------------|-----------------|-------------------|-----------------|
| M1 | Red Maple | 20 | 314 | 6 | 28.26 | 850 | 30.07785 | 61.00% | 6092.611 | 80.00% | 80.00% | 3899.27111 |

Arborist Report - 603 Woodland Avenue, Burlington, Ontario

Neighbouring Trees

Tree number N1 is a 25, 26cm dbh Mulberry White that is growing near the west property line in the backyard of 602 Waterloo Street. This tree is in fair condition and requires a tree protection zone of 2.4m.

Tree number N2 is a 35cm dbh Pine Eastern White that is growing near the south property line in the backyard of 2160 Courtland Drive. This tree is in fair condition and requires a tree protection zone of 2.4m.

Tree number N3 is a 40cm dbh Pine Eastern White that is growing near the south property line in the backyard of 2160 Courtland Drive. This tree is in fair condition and requires a tree protection zone of 2.4m.

Tree number N4 is a 20cm dbh Cedar Emerald Green that is growing near the east property line in the back yard of 605 Woodland Avenue. This tree is in fair condition and requires a tree protection zone of 2.4m.

Neighbour permission (in writing) will be required by the City of Burlington to issue any tree permit for injury or removal of shared or neighbouring trees.

Privately Owned Trees

Tree number P1 is a 15cm dbh Cedar White that is growing near the east property line of the subject property. This tree is in fair however it is recommended for removal due to development impacts.

Tree number P2 is a 15cm dbh Cedar White that is growing near the east property line in the backyard of the subject property. This tree is in fair condition and requires a tree protection zone of 2.4m.

Tree number P3 is a 12, 17cm dbh Elm Siberian that is growing near the east property line in the backyard of the subject property. This tree is in fair condition and requires a tree protection zone of 2.4m.

Tree number P4 is a 15cm dbh Cedar White that is growing near the east property line in the backyard of the subject property. This tree is in fair condition and requires a tree protection zone of 2.4m.

Tree number P5 is a 15cm dbh Cedar Emerald Green that is growing near the east property line in the backyard of the subject property. This tree is in fair condition and requires a tree protection zone of 2.4m.

Tree number P6 is a 24cm dbh Maple Norway that is growing near the north property line in the backyard of the subject property. This tree is in fair condition and requires a tree protection zone of 2.4m.

Tree number P7 is a 12cm dbh Maple Norway that is growing near the north property line in the backyard of the subject property. This tree is in fair condition and requires a tree protection zone of 2.4m.

Tree number P8 is a 18, 18, 25, 25cm dbh Mulberry White that is growing near the north property line in the backyard of the subject property. This tree is in fair condition and requires a tree protection zone of 2.4m.

Tree number P9 is a 15cm dbh Hemlock Eastern that is growing near the north property line in the backyard of the subject property. This tree is in fair condition and requires a tree protection zone of 2.4m.

Tree number P10 is a 15cm dbh Hemlock Eastern that is growing near the west property line in the backyard of the subject property. This tree is in fair condition and requires a tree protection zone of 2.4m.

Tree number P11 is a 15cm dbh Hemlock Eastern that is growing near the west property line in the backyard of the subject property. This tree is in fair condition and requires a tree protection zone of 2.4m.

Tree number P12 is a 15cm dbh Cedar White that is growing near the north property line in the backyard of the subject property. This tree is in fair condition and requires a tree protection zone of 2.4m.

Tree number P13 is a 15cm dbh Cedar White that is growing near the north property line in the backyard of the subject property. This tree is in fair condition and requires a tree protection zone of 2.4m.

Tree number P14 is a 12, 15, 16cm dbh Japanese Lilac that is growing near the west side of the front yard on the subject property. This tree is in poor condition and is recommended for removal due to its current state and development impacts.

All protective tree hoarding shall be installed prior to commencement of any construction activities as per City of Burlington specifications.

Arborist Report - 603 Woodland Avenue, Burlington, Ontario

Misidentification of species.

| Tree # | Common Name | Latin Name | DBH (cm) | Height (m) | Crown Reserve (m) | Crown Height (m) | Canopy Cover Area (m) | Health | Structure | TPZ (m) | Site Plan Results |
|--------|------------------------|------------------------------|----------|------------|-------------------|------------------|-----------------------|--------|-----------|---------|-------------------|
| M1 | Maple Red (soft maple) | Acer rubrum | 19 | 6 | 3 | 6 | 9 | fair | fair | 2.4m | preserve |
| N1 | Mulberry White | Morus alba | 36 | 9 | 7 | 5 | 49 | fair | poor | 2.4m | preserve |
| N2 | Pine Eastern White | Pinus strobus | 35 | 12 | 7 | 9 | 49 | fair | poor | 2.4m | preserve |
| N3 | Pine Eastern White | Pinus strobus | 40 | 18 | 10 | 15 | 100 | fair | fair | 2.4m | preserve |
| N4 | Cedar Emerald Green | Thuja occidentalis 'emerald' | 20 | 8 | 3 | 8 | 9 | fair | fair | 2.4m | preserve |
| P1 | Cedar White | Thuja occidentalis | 15 | 5 | 3 | 5 | 9 | fair | fair | 2.4m | remove |
| P2 | Cedar White | Thuja occidentalis | 15 | 4 | 3 | 4 | 9 | fair | fair | 2.4m | preserve |
| P3 | Elm Siberian | Ulmus pumila | 21 | 8 | 5 | 4 | 25 | fair | fair | 2.4m | preserve |
| P4 | Cedar White | Thuja occidentalis | 15 | 5 | 3 | 5 | 9 | fair | fair | 2.4m | preserve |
| P5 | Cedar Emerald Green | Thuja occidentalis 'emerald' | 15 | 7 | 1 | 7 | 1 | fair | fair | 2.4m | preserve |
| P6 | Maple Norway | Acer platanoides | 24 | 11 | 7 | 6 | 49 | fair | fair | 2.4m | preserve |
| P7 | Maple Norway | Acer platanoides | 12 | 9 | 5 | 4 | 25 | fair | poor | 2.4m | preserve |
| P8 | Mulberry White | Morus alba | 31 | 11 | 7 | 7 | 49 | fair | poor | 2.4m | preserve |
| P9 | Hemlock Eastern | Tsuga canadensis | 15 | 5 | 4 | 5 | 16 | fair | fair | 2.4m | preserve |
| P10 | Hemlock Eastern | Tsuga canadensis | 15 | 5 | 4 | 5 | 16 | fair | fair | 2.4m | preserve |
| P11 | Hemlock Eastern | Tsuga canadensis | 15 | 5 | 4 | 5 | 16 | fair | fair | 2.4m | preserve |
| P12 | Cedar White | Thuja occidentalis | 15 | 4 | 3 | 4 | 9 | fair | poor | 2.4m | preserve |
| P13 | Cedar White | Thuja occidentalis | 15 | 4 | 3 | 4 | 9 | fair | poor | 2.4m | preserve |
| P14 | Japanese Lilac | Syringa reticulata | 25 | 5 | 4 | 3 | 16 | poor | poor | 2.4m | remove |

Tree ownership is indicated by the tree naming system, tree names beginning with the letter M are municipally owned, tree names beginning with the letter N are on neighbouring properties within 6m of the property line and tree names beginning with the letter P are privately owned and on the subject property.

Arborist Report - 603 Woodland Avenue, Burlington, Ontario

Limitations of Assessment

It is the policy of Summit SKS Limited to attach the following clause in regards to limitations. This is to ensure that the client is fully aware of what is technically and professionally realistic in the preservation and assessment of trees in the urban environment.

The assessment of the trees in this report has been done in conjunction with and according to accepted arboriculture methods and techniques. These include an examination of the above ground parts of the tree for structural defects, scars, cracks, the overall condition of the visible root structures, the severity and direction of lean (if any), the general condition of the trees and the surrounding environment, external indications of decay such as fungal fruiting bodies, evidence of attack by insects, symptoms of infestation and pathogens, discoloured foliage, and the proximity of potential targets should a tree fail. Except where specifically noted, the trees not cored, probed or climbed and there was no detailed inspection of the root crowns involving excavations, or samples taken to be scientifically tested.

Notwithstanding the recommendations and conclusions presented in this report, it must be acknowledged that trees are living organisms. They are not immune to changes in site conditions, dramatic weather events or seasonal variations in climate. Therefore it should always be recognized that trees are ever evolving and their health and vigour constantly vary over time. While all reasonable efforts have been made to ensure that the subject trees are healthy, no guarantees are offered or implied that these trees or part(s) of any trees will remain intact.

It is professionally and practically impossible to predict with absolute certainty the behaviour of any tree or its component parts under all circumstances and variables. Most trees have the potential for failure under adverse weather conditions and the risk can only be completely eliminated if the tree is removed. Inherently, a standing tree will always pose some level of risk. Although every effort has been made to ensure that this assessment is reasonably accurate, trees should be re-assessed periodically. The assessment presented in this report is valid at the time of inspection.

The report is the property of Summit SKS Limited and/or its agents and may not be used until payment is made in full unless written permission is granted to do so. Summit SKS Limited reserves the right to withdraw this report and its recommendations, if any requirements are not met. All details and graphics are copyright of Summit SKS Limited.

On Behalf of Summit SKS Limited



Stephen Shelton,
Certified Arborist ON-0542AT





The International Society of Arboriculture

Hereby Announces That

Stephen W. Shelton

Has Earned the Credential

ISA Certified Arborist ®

By successfully meeting ISA Certified Arborist certification requirements through demonstrated attainment of relevant competencies as supported by the ISA Credentialing Council

Caitlyn Pollihan
Caitlyn Pollihan
CEO & Executive Director

| | | |
|---------------|-----------------|----------------------|
| 18 March 2000 | 30 June 2024 | ON-0542AT |
| Issue Date | Expiration Date | Certification Number |

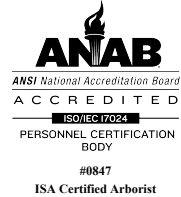

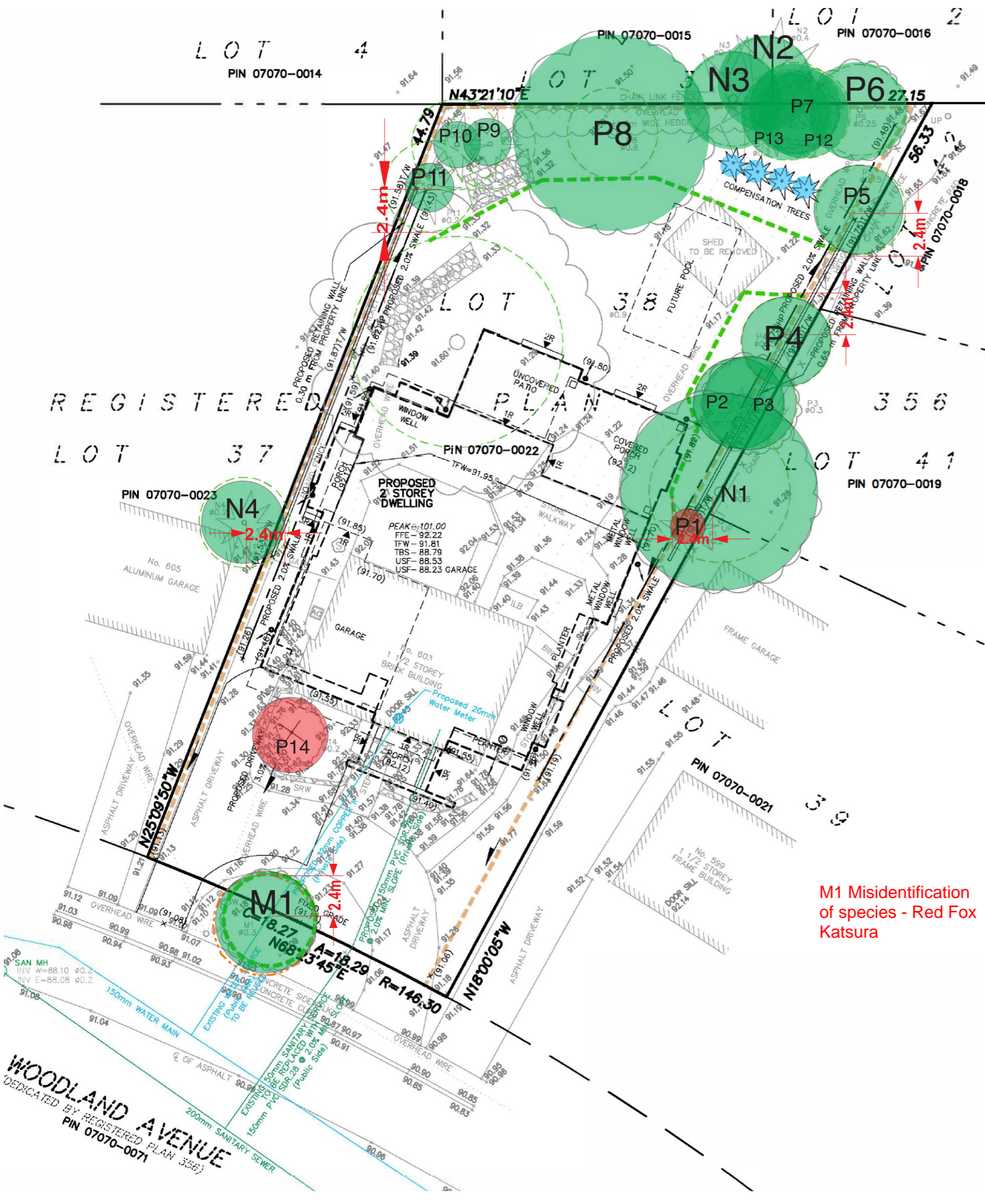

M1 Misidentification of species - Red Fox Katsura

2m

- LEGEND**
- property line
 - existing tree number (refer to chart)
 - existing vegetation to remain
 - existing vegetation to be removed
 - minimum tree protection zone (MTPZ) - as per Town of Oakville guidelines
 - compensation trees
 - tree protection

Tree Protection and Preservation Specification No.: SS12A

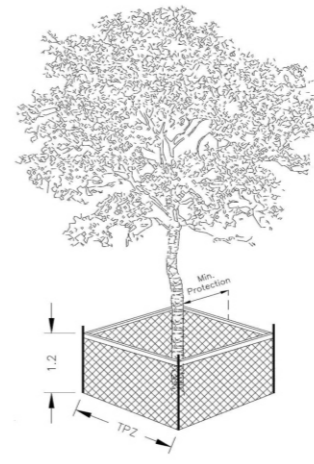

Detail TP-1 - Tree Protection Detail.

| Trunk Diameter (DBH) ¹ | Minimum Tree Protection Zone (MTPZ) Distances Required ² | Critical Root Zone (CRZ) Distances Required ^{3,4} |
|-----------------------------------|---|--|
| < 10 cm | 1.8 m | 1.8 m |
| 11 - 40 cm | 2.4 m | 4.0 m |
| 41 - 50 cm | 3.0 m | 5.0 m |
| 51 - 60 cm | 3.6 m | 6.0 m |
| 61 - 70 cm | 4.2 m | 7.0 m |
| 71 - 80 cm | 4.8 m | 8.0 m |
| 81 - 90 cm | 5.4 m | 9.0 m |
| 91 - 100+ cm | 6.0 m | 10.0 m |

NOTES:

- The roots of a tree can extend from the trunk to approximately 2-3 times the distance of the drip line.
- Diameter at breast height (DBH) is the measurement of tree trunk taken at 1.4 metres above ground.
- Minimum Tree Protection Zone and Critical Root Zone distances are to be measured from the outside edge of the tree base towards the drip line and may be limited by an existing paved surface, provided the existing paved surface remains intact throughout the construction work and is subject to Section 6 of this specification.
- Where work is being performed beyond the Minimum Tree Protection Zone but within the Critical Root Zone the works are subject to Section 8 of this specification.

NOTE: Vegetation inventory undertaken by Stephen Shelton, ISA Certified Arborist (ON-#0542A1)

REVISIONS/ SUBMISSIONS

| # | DATE | DESCRIPTION |
|---|--------------|----------------|
| 1 | 1 April 2022 | 1st Submission |
| 2 | 25 OCT 2022 | 2nd Submission |
| 3 | | |
| 4 | | |
| 5 | | |

CERTIFICATIONS

TRAQ 1589 ON-0542AT

CLIENT
Carrothers + Associates

MUNICIPALITY
City of Burlington

PROJECT
Private Residence
603 Woodland Avenue

MUNICIPAL FILE NUMBER
#-

SHEET
Tree Protection Plan

| Tree Number | Common Name | Latin Name | DBH (cm) | Height (m) | Crown Reserve (m) | Crown Height (m) | Canopy Cover Area (m) | Health | Structure | TPZ (m) | Site Plan Results |
|-------------|------------------------|------------------------------|----------|------------|-------------------|------------------|-----------------------|--------|-----------|---------|-------------------|
| M1 | Maple Red (soft maple) | Acer rubrum | 10 | 6 | 3 | 6 | 9 | fair | fair | 1.8m | preserve |
| N1 | Mulberry White | Morus alba | 36 | 9 | 7 | 5 | 49 | fair | poor | 2.4m | preserve |
| N2 | Pine Eastern White | Pinus strobus | 35 | 12 | 7 | 9 | 49 | fair | poor | 2.4m | preserve |
| N3 | Pine Eastern White | Pinus strobus | 40 | 18 | 10 | 15 | 100 | fair | fair | 2.4m | preserve |
| N4 | Cedar Emerald Green | Thuja occidentalis 'emerald' | 20 | 8 | 3 | 8 | 9 | fair | fair | 2.4m | preserve |
| P1 | Cedar White | Thuja occidentalis | 15 | 5 | 3 | 5 | 9 | fair | fair | 2.4m | remove |
| P2 | Cedar White | Thuja occidentalis | 15 | 4 | 3 | 4 | 9 | fair | fair | 2.4m | preserve |
| P3 | Elm Siberian | Ulmus pumila | 21 | 8 | 5 | 4 | 25 | fair | fair | 2.4m | preserve |
| P4 | Cedar White | Thuja occidentalis | 15 | 5 | 3 | 5 | 9 | fair | fair | 2.4m | preserve |
| P5 | Cedar Emerald Green | Thuja occidentalis 'emerald' | 15 | 7 | 1 | 7 | 1 | fair | fair | 2.4m | preserve |
| P6 | Maple Norway | Acer platanoides | 24 | 11 | 7 | 6 | 49 | fair | fair | 2.4m | preserve |
| P7 | Maple Norway | Acer platanoides | 12 | 9 | 5 | 4 | 25 | fair | poor | 2.4m | preserve |
| P8 | Mulberry White | Morus alba | 44 | 11 | 7 | 7 | 49 | fair | poor | 3m | preserve |
| P9 | Hemlock Eastern | Tsuga canadensis | 15 | 5 | 4 | 5 | 16 | fair | fair | 2.4m | preserve |
| P10 | Hemlock Eastern | Tsuga canadensis | 15 | 5 | 4 | 5 | 16 | fair | fair | 2.4m | preserve |
| P11 | Hemlock Eastern | Tsuga canadensis | 15 | 5 | 4 | 5 | 16 | fair | fair | 2.4m | preserve |
| P12 | Cedar White | Thuja occidentalis | 15 | 4 | 3 | 4 | 9 | fair | poor | 2.4m | preserve |
| P13 | Cedar White | Thuja occidentalis | 15 | 4 | 3 | 4 | 9 | fair | poor | 2.4m | preserve |
| P14 | Japanese Lilac | Syringa reticulata | 25 | 5 | 4 | 3 | 16 | poor | poor | 2.4m | remove |

5-871 Equestrian Court
Oakville, ON L6L 6L7
1.289.830.8900
www.summits.ca