

Sketch No. 1
CONCEPT PLAN



The applicant is proposing to amend the City of Burlington Official Plan and Zoning By-law to permit an 11 storey building with a mechanical penthouse which would contain 93 residential units which are identified as a mix of 1, 2 and 3 bedroom units, a parking rate of 0.73 spaces per unit (68 total parking spaces), and access provided from Brant Street.

File Nos.505-01/26
& 520-01/26

 SUBJECT PROPERTY - - Bus Route ● Bus Stop

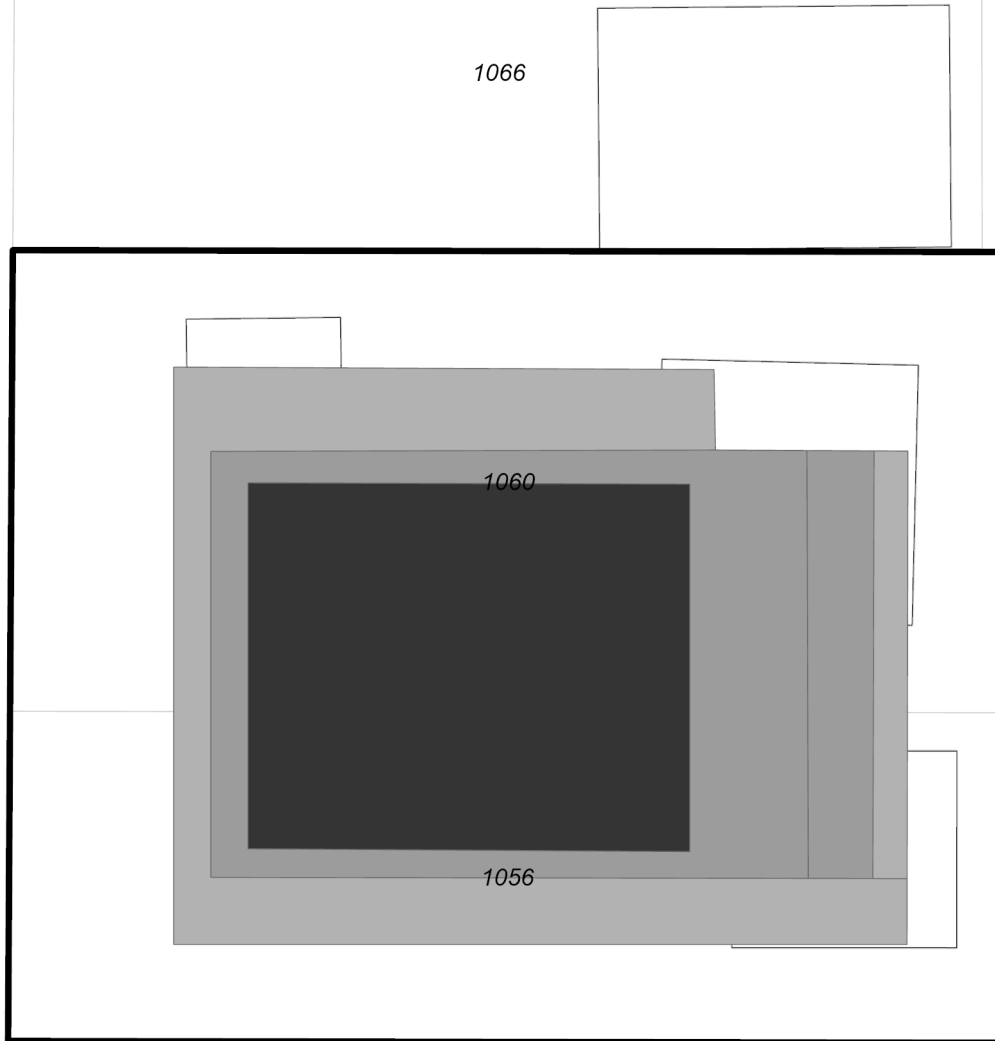

BRANT ST.

